

The Iron Press

Moran Iron Works, Inc.

New Additions

On Tuesday, March 8th the newest additions to our trucking fleet rolled into the yard with much excitement. An Oshkosh M911 (as pictured to the right) was chosen as the ideal truck that is suitable for moving our heaviest fabrications, accompanying it (not shown) is a M747 trailer. With the increasing weight of our products, we found that we would need to increase the power of our hauler, and did we ever. The 911 packs a Detroit driven 8V-92TA at 450HP that has enough torque to haul a gross combined weight of 150 ton! Even with the trucks rugged makeup it is still pleasantly functional and features specifications such as an automatic transmission, comfortable seating and an enclosed cab.

Due to the size and weight of the Oshkosh M911 a special mobile Equipment Plate is required when it travels down public roadways. We have high expectations for this truck and



trailer combination. It will be dedicated to haul our ever increasing sized loads, that have approached the point of over taxing our existing hauling equipment. Completely functional as is, it is presently undergoing a little cosmetic touch up, along with a new civilian paint job.

Fourth of July Float

Like every year, Moran Iron Works is secretly working on the Fourth of July float. Per this writers eyes, 2011's float is going to be amazing. I've seen the blueprints and construction involving many employees and volunteers. Previous years have resulted in creations such as the large Iron Man Transformer, the Iron Butterfly and many more impressive feats. Mark your calendars for Onaway's Annual Fourth of July Parade for the exciting unveiling.



March 2011

Moran Iron Works

11739 M-68/33

Onaway, MI 49765

Ph. 989.733.2011

Fx. 989.733.2371

Web: www.moraniron.com

Email: Sales@moraniron.com

ITI
International
Testing &
Inspection

- Non-Destructive Testing
- Ultrasonic (UT) • Magnetic Particle (MT) • Liquid Penetrate (PT)
- Visual (VT) • Certified Weld Inspection

**International Testing
& Inspection, LLC.**

6911 Bowen Rd

Onaway, MI 49765

Ph: 989.733.9800

Fax: 989.733.2371

Spring Conferences

CTOTF Users Forum

Membership organization of Combustion Turbine
Owners/Operators

April 2011,

West Palm Beach, Florida

Electric Power Show

Industry's Fastest Growing Power Conference &
Exhibition

May 2011,

Chicago, Illinois

The New Addition is Set to Break Ground April 2011

As the size of our fabrications keeps increasing, our building size must also. Due to an expected workload increase, an expansion of our shop is necessary to meet our customers needs into the future.

The addition, as the drawing to the right depicts, is planned to be our largest workspace yet. Not only will the shop itself be 200 ft long by 120 ft wide, but also have a 70 ft x 41 ft breezeway leading into it. The breezeway will connect to our existing facility.

The shop will have two separate bay areas. Both bays will be equipped with two 30 ton bridge cranes with a 5 ton auxiliary crane. Along with that each bay will also have a 15 ton bridge crane. The expansion will have (4) bi-fold hanger doors, (2) in each bay. These large doors will increase the ease of moving products outside of the shop at completion.

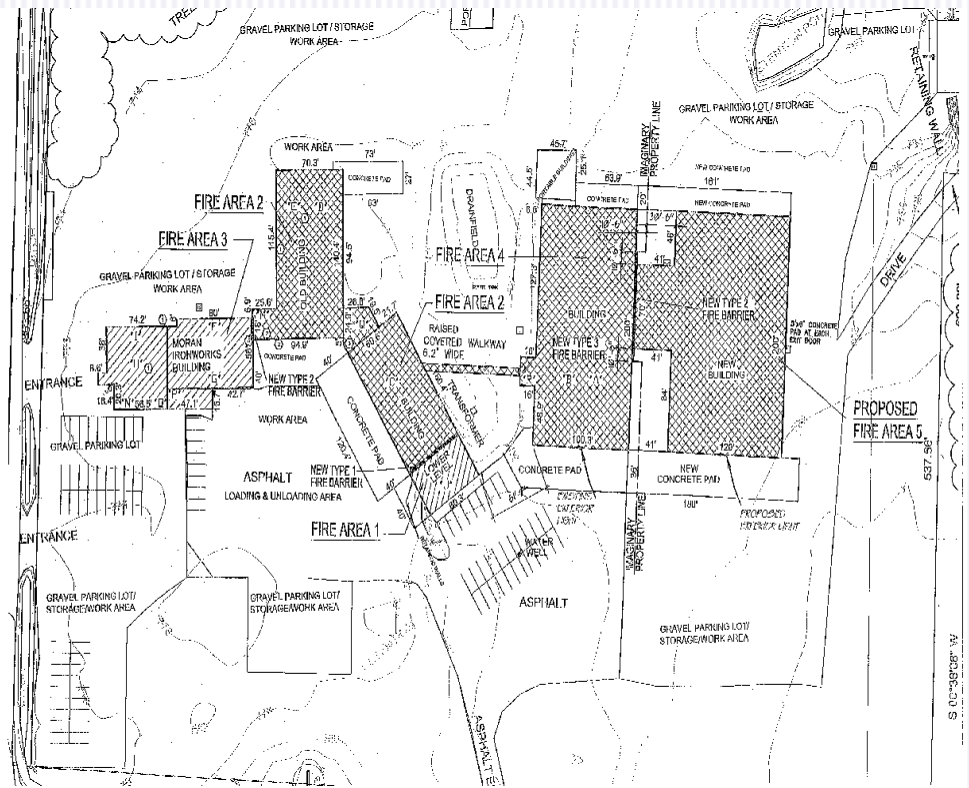

New Employee

In January a new certified welder joined our ranks, Jeff Whalen. Jeff brings with him years of experience in the welding industry and multiple certifications. He does confess to being a bit of a workaholic, but when he has spare time he likes to spend it with his family; wife Cindy, his two grown children, and of course his young grandson Skylar. Jeff is fast establishing himself as a useful resource to have on our team. Welcome Aboard Jeff!

